

## Sponsorship

LED Okamura is  
an official sponsor of S Road MOLA GT-R.



LED Okamura is supporting S Road MOLA GT-R as an official sponsor to  
contribute the development of motorsports.

**2015 SUPER GT**  
**The 3rd stage Thailand**

**2015**  
**SUPER GT ROUND 3**  
**GT500 CLASS**  
**BURIRAM SUPER GT RACE**  
**WINNER**



## Producing lighting system for S Road MOLA GT-R.

LED Okamura produced lighting system for the pit garage of S Road MOLA GT-R.  
Our lighting system was made for showing up the GT racing car attractively and  
for high usability for team engineers and staff.

**MOLA**

Copyright © 2000-2015 MOLA INTERNATIONAL CO.,LTD. All rights reserved.



**LED OKAMURA**  
LED OKAMURA HK LIMITED

PRODUCT CATALOGUE

**2016**

**工之助 LED Series**  
[ECO-NO-SUKE]



**For The Best  
Shop Lighting**



<http://www.ledokamura.com.hk>





Boutique



Supermarket



Jewelry Shop



Restaurant

Different white tints for different types of shop.



The most suitable lighting solution for professional.

工之助 LED Series [ECO-NO-SUKE]

**for Shop**  
Perfect light for more vibrant and accurate colors.  
→ P.6

**for Supermarket**  
Specially tuned light to enhance the attractiveness of food.  
→ P.26



Premium Line  
LED30W | 40W  
For Shops & Supermarket  
[Color Selectable]  
→ P.15

For Apparel & Shops

Track Lights

LED20W   30W [Color Selectable] → P.18	LED20W   40W [Color Selectable] → P.20	LED10W → P.22

Downlights

LED30W [Color Selectable] → P.24	LED30W → P.24	LED30W → P.24	LED13W → P.25	LED13W → P.25	LED13W → P.25

For Supermarket

Track Lights

LED30W   40W [Color Selectable] → P.29	LED20W   30W [Color Selectable] → P.32	LED20W   30W [Color Selectable] → P.34	LED30W [Color Selectable] → P.36

Downlights

LED30W [Color Selectable] → P.37	LED30W → P.37	LED30W → P.37



For your best shop lighting **Lighting Planning**

## Advanced lighting solution for comfortable and attractive shop atmosphere

Okamura provides high level lighting solution for comfortable and attractive shop atmosphere which realizes clients' shop image. Okamura's lighting solution achieves both attractiveness of the shop and high energy efficiency.

### ① Understanding clients' needs

Understanding clients' needs and choosing suitable lighting fixtures with high energy efficiency.



### ② Lighting planning

Okamura creates lighting planning which realizes clients' shop image with energy efficiency.

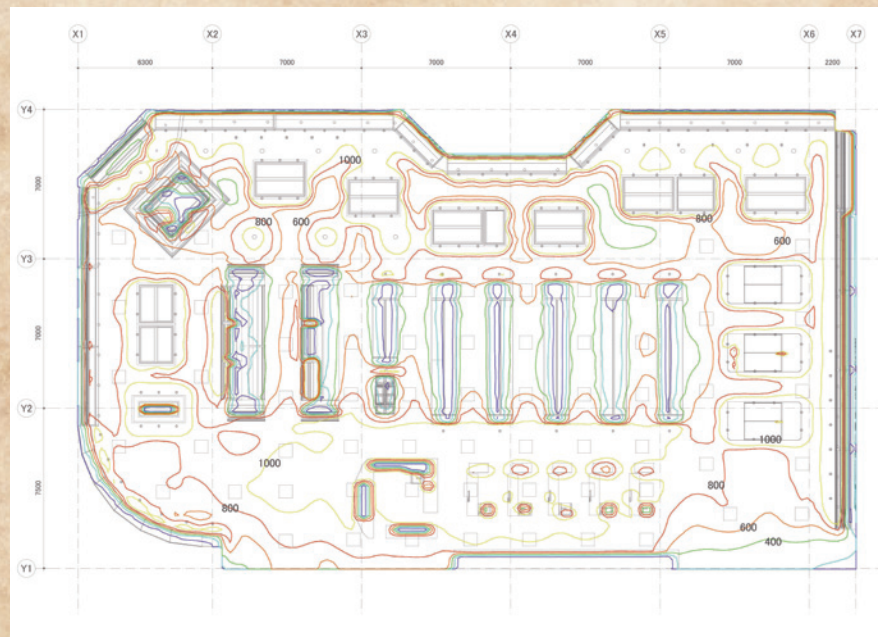
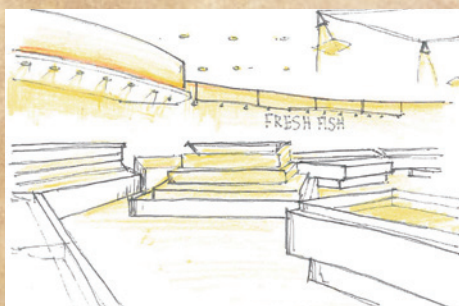
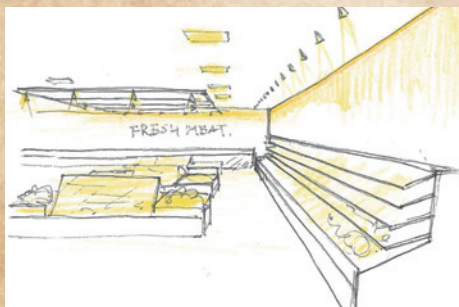

### ③ Lighting simulation

Okamura provides illuminance simulation or 3D perspective image for clients.



■ 3D Illuminance image

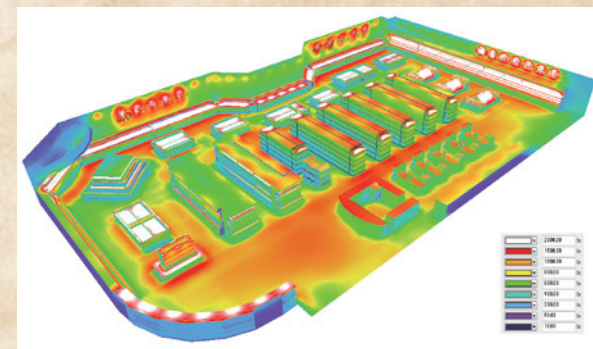

■ Selecting lighting fixtures and filters



### ④ Completion of lighting planning

After some adjustment, Okamura provides completed lighting planning to clients.

### Lighting design team in Tokyo and in Vietnam

■ Lighting Design Team in Tokyo



■ Lighting Design Team in Vietnam





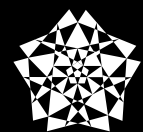

APPAREL GOOD

## True black and white color technology for dramatic atmosphere of apparel shops.

Okamura developed APPAREL GOOD technology which brings true colors for apparel shops. Texture of fabrics and each color differentiated correctly with the light.

technology which brings true colors for apparel shops.

appear dramatically and even slightly different colors such as black, dark grey, navy blue can be APPAREL GOOD is the desired high quality light for apparel shops.





## Illuminating fabrics in true colors

### Okamura's original true color technology

Combination of the latest phosphor technology and Okamura's original APPAREL GOOD filter enables to illuminate fabrics in true colors.

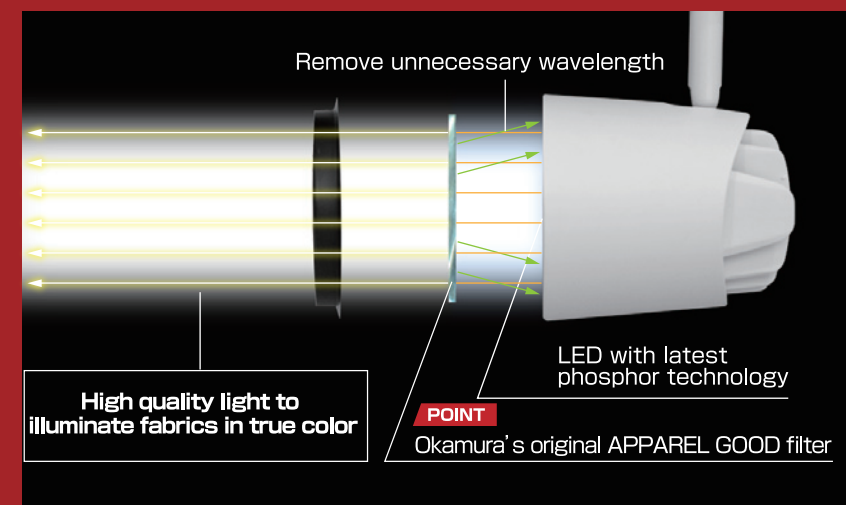

## Clear light made for expressing pure white

### Clear light which expresses fabric and details of texture presses whiteness of texture

White light often illuminates white fabrics yellowish. APPAREL GOOD light illuminates texture of fabrics or lace fabrics

fabrics yellowish. white fabrics in clear white and appears.



## Rich texture of black fabric

### High visibility of slightly different colors

APPAREL GOOD illuminates fabrics in true colors and also, texture of fabrics appears.

The light enables high visibility of slightly different colors such as black, dark grey, navy blue and color tones.

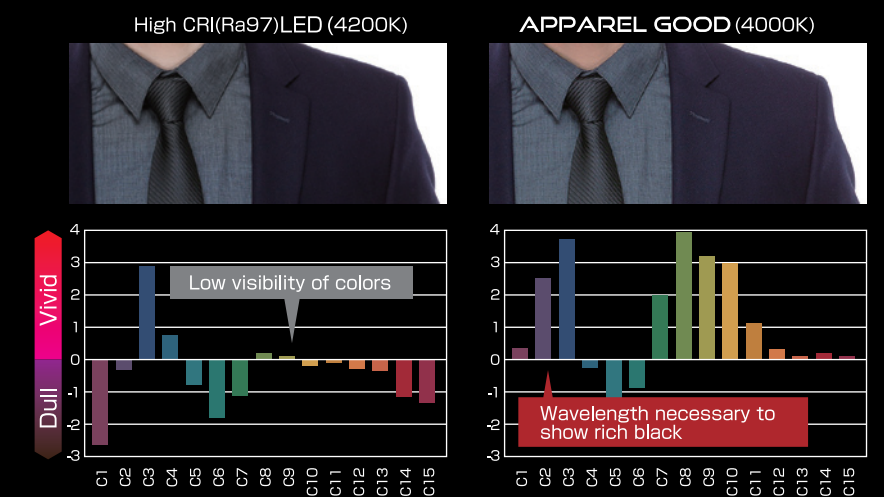

※C1 - C15 is colored examination for evaluations to express the vividness (chroma) of the color.



# Installation Examples [Shops]





# Installation Examples [Supermarket]







Lighting Layout Drawing (HID)

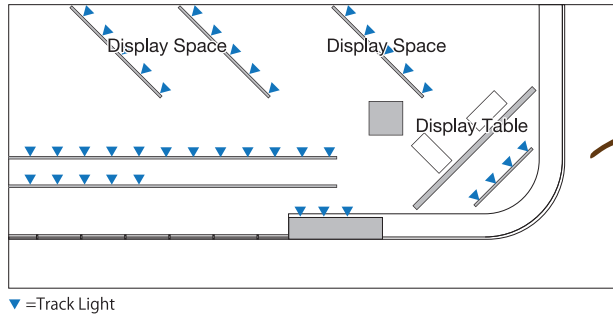

Lighting Layout Drawing (LED)

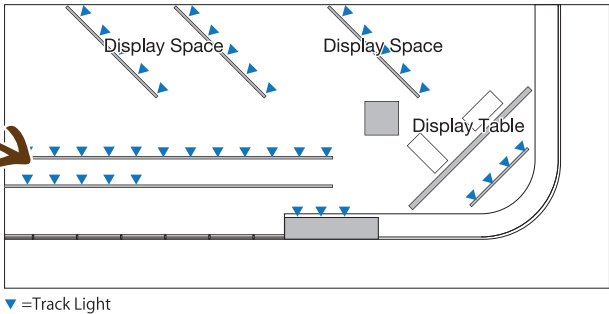

Running Cost Simulation [Boutique : 39 Track Lights]

	Conventional HID 30W Track Light		Our LED 30W Track Light	
Illuminance(@1m)	10712 lx	+1369 lx	12081 lx	
Power Consumption	44W	Consumption -32%	30.2W	
Annual Electrical Cost	955€	Saving 300 €	655€	

\*Calculation conditions -> Number of fixtures : 39 / Electricity cost : 0.1276/kWh / HID's power consumption : 44W / LED's power consumption : 30.2W / Running time : 12h/day / Running days : 365days

Premium Line

LED 30W

●2700K/3500K/4000K  
OECD-EU30(White/Black)  
[Normal Type]

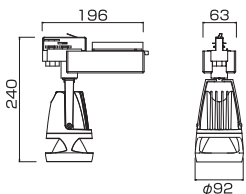

[Specification]  
Power Consumption : 30.2W (@240V)  
Input Voltage : 100-240VAC (50/60Hz)  
Luminous flux : 2569 lm (Medium 4000K)  
CCT : 2700K/3500K/4000K  
CRI : 93  
Weight : 1.1kg  
Lifetime : 40000 hours \*

[Beam Angle]  
▲ Medium ▲ Wide

Premium Line

LED 30W

●2700K/3500K/4000K  
OECD-EUS30(White/Black)  
[Anti-dazzle Type]

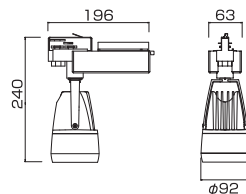

[Specification]  
Power Consumption : 30.2W (@240V)  
Input Voltage : 100-240VAC (50/60Hz)  
Luminous flux : 2569 lm (Medium 4000K)  
CCT : 2700K/3500K/4000K  
CRI : 93  
Weight : 1.3kg  
Lifetime : 40000 hours \*

[Beam Angle]  
▲ Medium ▲ Wide

OPTIONS

[Glass Filters]

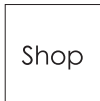

Apparel Good Filter

\*=Operating environment: below 30°C. Estimated lifetime is determined as the total operating hour until the end of life of LED module or total operating our until total lumen output decreases to the 70% of initial total lumen output (L70).



# Color Selectable Track Lights



# Installation examples



Premium Line

LED 40w

●2700K/3500K/4000K  
OECD-EU40(White/Black)  
[Normal Type]

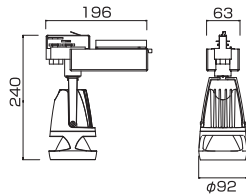

[Specification]  
Power Consumption : 37.7W (@240V)  
Input Voltage : 100-240VAC (50/60Hz)  
Luminous flux : 3015 lm (Medium 4000K)  
CCT : 2700K/3500K/4000K  
CRI : 93  
Weight : 1.1kg  
Lifetime : 40000 hours \*

[Beam Angle]  
▲ Medium ▲ Wide

Premium Line

LED 40w

●2700K/3500K/4000K  
OECD-EUS40(White/Black)  
[Anti-dazzle Type]

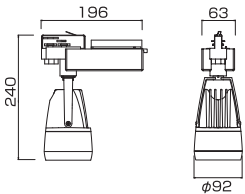

[Specification]  
Power Consumption : 37.7W (@240V)  
Input Voltage : 100-240VAC (50/60Hz)  
Luminous flux : 3015 lm (Medium 4000K)  
CCT : 2700K/3500K/4000K  
CRI : 93  
Weight : 1.3kg  
Lifetime : 40000 hours \*

[Beam Angle]  
▲ Medium ▲ Wide



## OPTIONS

[Glass Filters]



Apparel Good Filter

\*=Operating environment: below 30°C. Estimated lifetime is determined as the total operating hour until the end of life of LED module or total operating our until total lumen output decreases to the 70% of initial total lumen output (L70).



# Color Selectable Track Lights



LED 20w  
●3000K/4000K  
OFND-CAS/20(White)

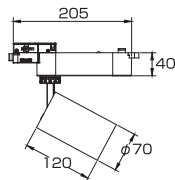

[Specification]  
Power Consumption : 23.0W (@240V)  
Input Voltage : 100-240VAC (50/60Hz)  
Luminous flux :1786 lm (Medium 3000K)  
CCT : 3000K/4000K  
CRI : 80  
Weight : 1.0kg  
Lifetime : 40000 hours \*

[Beam Angle]  
▲ Narrow ▲ Medium

LED 20w  
●3000K/4000K  
OFND-CAS/20(Black)

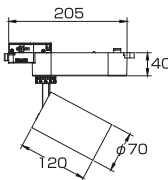

[Specification]  
Power Consumption : 23.0W (@240V)  
Input Voltage : 100-240VAC (50/60Hz)  
Luminous flux :1786 lm (Medium 3000K)  
CCT : 3000K/4000K  
CRI : 80  
Weight : 1.0kg  
Lifetime : 40000 hours \*

[Beam Angle]  
▲ Narrow ▲ Medium

# Color Selectable Track Lights



LED 30w  
●3000K/4000K  
OFND-CAS/30(White)

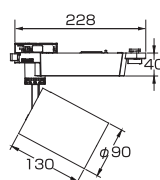

[Specification]  
Power Consumption : 28.0W (@240V)  
Input Voltage : 100-240VAC (50/60Hz)  
Luminous flux : 2675 lm (Medium 3000K)  
CCT : 3000K/4000K  
CRI : 80  
Weight : 1.5kg  
Lifetime : 40000 hours \*

[Beam Angle]  
▲ Narrow ▲ Medium

LED 30w  
●3000K/4000K  
OFND-CAS/30(Black)

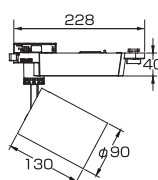

[Specification]  
Power Consumption : 28.0W (@240V)  
Input Voltage : 100-240VAC (50/60Hz)  
Luminous flux : 2675 lm (Medium 3000K)  
CCT : 3000K/4000K  
CRI : 80  
Weight : 1.5kg  
Lifetime : 40000 hours \*

[Beam Angle]  
▲ Narrow ▲ Medium

## OPTIONS

[Glass Filters]



\*=Operating environment: below 30°C. Estimated lifetime is determined as the total operating hour until the end of life of LED module or total operating our until total lumen output decreases to the 70% of initial total lumen output (L70).

## OPTIONS

[Glass Filters]



\*=Operating environment: below 30°C. Estimated lifetime is determined as the total operating hour until the end of life of LED module or total operating our until total lumen output decreases to the 70% of initial total lumen output (L70).



# Color Selectable Track Lights



LED 20w  
●3000K/4000K  
OFND-AS/20(White)

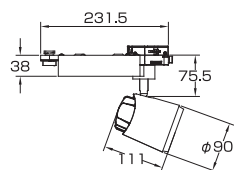

[Specification]  
Power Consumption : 17.0W (@240V)  
Input Voltage : 100-240VAC (50/60Hz)  
Luminous flux : 1126 lm (Medium 4000K)  
CCT : 3000K/4000K  
CRI : 90  
Weight : 1.2kg  
Lifetime : 40000 hours\*

[Beam Angle]  
▲ Narrow ▲ Medium

LED 20w  
●3000K/4000K  
OFND-AS/20(Black)

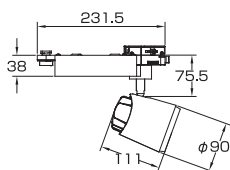

[Specification]  
Power Consumption : 17.0W (@240V)  
Input Voltage : 100-240VAC (50/60Hz)  
Luminous flux : 1126 lm (Medium 4000K)  
CCT : 3000K/4000K  
CRI : 90  
Weight : 1.2kg  
Lifetime : 40000 hours\*

[Beam Angle]  
▲ Narrow ▲ Medium

# Color Selectable Track Lights



LED 40w  
●3000K/4000K  
OFND-AS/40(White)

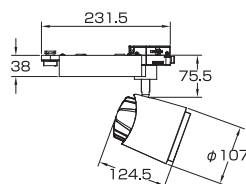

[Specification]  
Power Consumption : 41.5W (@240V)  
Input Voltage : 100-240VAC (50/60Hz)  
Luminous flux : 2526 lm (Medium 4000K)  
CCT : 3000K/4000K  
CRI : 90  
Weight : 1.3kg  
Lifetime : 40000 hours\*

[Beam Angle]  
▲ Narrow ▲ Medium

LED 40w  
●3000K/4000K  
OFND-AS/40(Black)

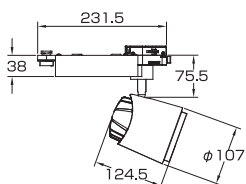

[Specification]  
Power Consumption : 41.5W (@240V)  
Input Voltage : 100-240VAC (50/60Hz)  
Luminous flux : 2526 lm (Medium 4000K)  
CCT : 3000K/4000K  
CRI : 90  
Weight : 1.3kg  
Lifetime : 40000 hours\*

[Beam Angle]  
▲ Narrow ▲ Medium

## OPTIONS

[Glass Filters]



Apparel Good Filter

\*=Operating environment: below 30℃. Estimated lifetime is determined as the total operating hour until the end of life of LED module or total operating our until total lumen output decreases to the 70% of initial total lumen output (L70).

## OPTIONS

[Glass Filters]



Apparel Good Filter

\*=Operating environment: below 30℃. Estimated lifetime is determined as the total operating hour until the end of life of LED module or total operating our until total lumen output decreases to the 70% of initial total lumen output (L70).



# Track Lights



# Installation examples



**LED 10w**  
●3000K/4000K  
OWPD-EU/10(White)  
CE

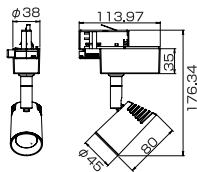
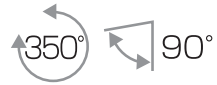

[Specification]  
Power Consumption : 9.6W (@240V)  
Input Voltage : 100-240VAC (50/60Hz)  
Luminous flux : 684 lm (Medium 3000K)  
CCT : 3000K/4000K  
CRI : 80  
Weight : 0.4kg  
Lifetime : 40000 hours\*

[Beam Angle]  
▲ Narrow ▲ Medium ▲ Wide

**LED 10w**  
●3000K/4000K  
OWPD-EU/10(Black)  
CE

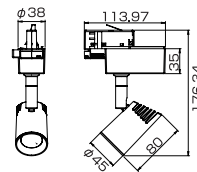

[Specification]  
Power Consumption : 9.6W (@240V)  
Input Voltage : 100-240VAC (50/60Hz)  
Luminous flux : 684 lm (Medium 3000K)  
CCT : 3000K/4000K  
CRI : 80  
Weight : 0.4kg  
Lifetime : 40000 hours\*

[Beam Angle]  
▲ Narrow ▲ Medium ▲ Wide



\*=Operating environment: below 30°C. Estimated lifetime is determined as the total operating hour until the end of life of LED module or total operating our until total lumen output decreases to the 70% of initial total lumen output (L70).





# Color Selectable Downlights



LED 30W  
●2700K/3000K/3500K/4000K  
OMO-1DWN30W-01  
CE

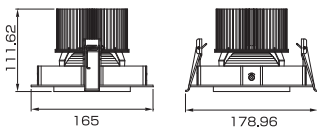

[Specification]  
Power Consumption : 31.1W (@240V)  
Input Voltage : 220-240VAC (50/60Hz)  
Luminous flux : 2349 lm (Wide 3000K)  
CCT : 2700K/3000K/3500K/4000K  
CRI : 80  
Weight : 0.8kg (Power Supply 0.4kg)  
Lifetime : 40000 hours\*

[Beam Angle]  
▲ Narrow ▲ Medium ▲ Wide

LED 30W  
●3000K  
OMO-1DWN30W-04  
CE

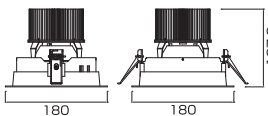

[Specification]  
Power Consumption : 31.1W (@240V)  
Input Voltage : 220-240VAC (50/60Hz)  
Luminous flux : 2305 lm (Medium)  
CCT : 3000K  
CRI : 80  
Weight : 1.0kg (Power Supply 0.4kg)  
Lifetime : 40000 hours\*

[Beam Angle]  
▲ Narrow ▲ Medium ▲ Wide

LED 30W X2  
●3000K  
OMO-2DWN30W-04  
CE

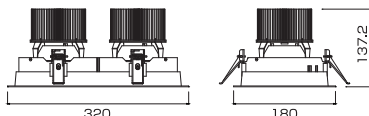

[Specification]  
Power Consumption : 31.1W X2 (@240V)  
Input Voltage : 220-240VAC (50/60Hz)  
Luminous flux : 2305 lm X2 (Medium)  
CCT : 3000K  
CRI : 80  
Weight : 1.9kg (Power Supply 0.4kg X2)  
Lifetime : 40000 hours\*

[Beam Angle]  
▲ Narrow ▲ Medium ▲ Wide

# Adjustable Downlights



LED 13W  
●3000K  
OFNW-75AS/12

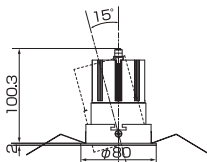

[Specification]  
Power Consumption : 13.0W (@240V)  
Input Voltage : 220-240VAC (50/60Hz)  
Luminous flux : 1085 lm (Medium 3000K)  
CCT : 3000K  
CRI : 80  
Weight : 0.3kg (Power Supply 83g)  
Lifetime : 40000 hours\*

[Beam Angle]  
▲ Narrow ▲ Medium ▲ Wide

LED 13W  
●3000K  
OFNW-90AS/12

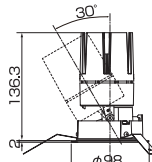

[Specification]  
Power Consumption : 13.0W (@240V)  
Input Voltage : 220-240VAC (50/60Hz)  
Luminous flux : 977 lm (Medium 3000K)  
CCT : 3000K  
CRI : 80  
Weight : 0.4kg (Power Supply 83g)  
Lifetime : 40000 hours \*

[Beam Angle]  
▲ Narrow ▲ Medium ▲ Wide

LED 13W  
●3000K  
OFNW-100AS/12

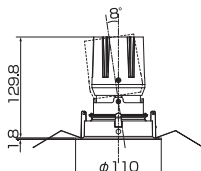

[Specification]  
Power Consumption : 14.4W (@240V)  
Input Voltage : 220-240VAC (50/60Hz)  
Luminous flux : 1055 lm (Medium 3000K)  
CCT : 3000K  
CRI : 80  
Weight : 0.5kg (Power Supply 83g)  
Lifetime : 40000 hours \*

[Beam Angle]  
▲ Narrow ▲ Medium ▲ Wide

## OPTIONS (For OMO-1DWN30W-01)

[Glass Filters]



Apparel Good Filter

\*=Operating environment: below 30°C. Estimated lifetime is determined as the total operating hour until the end of life of LED module or total operating our until total lumen output decreases to the 70% of initial total lumen output (L70).

\*=Operating environment: below 30°C. Estimated lifetime is determined as the total operating hour until the end of life of LED module or total operating our until total lumen output decreases to the 70% of initial total lumen output (L70).





## Feature 1

Specially tuned light to enhance different kinds of food.

Different specific white tints to make the food looking fresh, crisp, and visually enticing. Filters available for meat, fish but also bread and vegetables.

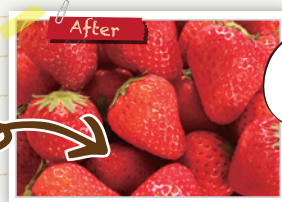

Beautifully red and tasty!

## Feature 2

Perfect light for more vibrant and accurate colors.

Our special filters enhance the colors, shapes and textures of food enabling to create a dynamic and customer friendly atmosphere.



Sharp and vivid colors!





Lighting Layout Drawing (HID)

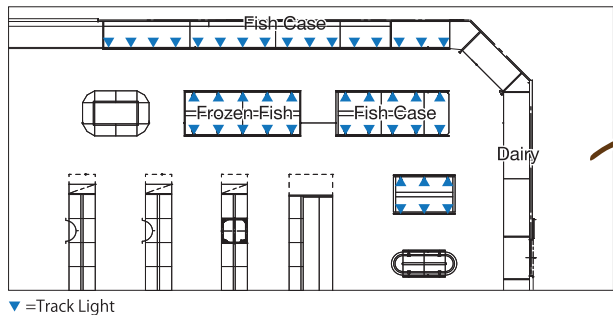

Lighting Layout Drawing (LED)

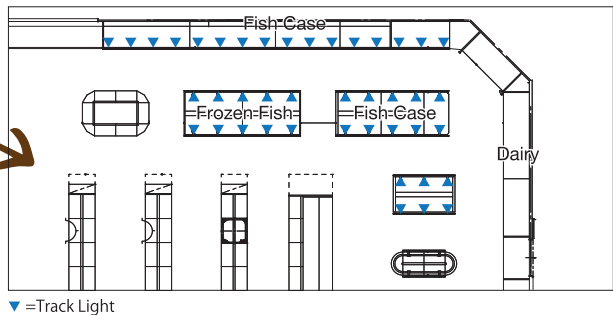

Running Cost Simulation [Supermarket : 42 Track Lights]

	Conventional HID 30W Track Light		Our LED 30W Track Light	
Illuminance(@1m)	10712 lx	+1369 lx	12081 lx	
Power Consumption	44W	Consumption -32%	30.2W	
Annual Electrical Cost	1028€	Saving 322 €	706€	

\*Calculation conditions -> Number of fixtures : 42 / Electricity cost : 0.1276/kWh / HID's power consumption : 44W / LED's power consumption : 30.2W / Running time : 12h/day / Running days : 365days

Premium Line

LED 30W

●2700K/3500K/4000K  
OECD-EU30(White/Black)  
[Normal Type]

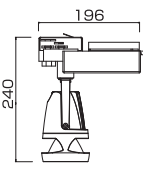

[Specification]  
Power Consumption : 30.2W (@240V)  
Input Voltage : 100-240VAC (50/60Hz)  
Luminous flux : 2569 lm (Medium 4000K)  
CCT : 2700K/3500K/4000K  
CRI : 93  
Weight : 1.1kg  
Lifetime : 40000 hours\*

[Beam Angle]  
▲ Medium ▲ Wide

Premium Line

LED 30W

●2700K/3500K/4000K  
OECD-EUS30(White/Black)  
[Anti-dazzle Type]

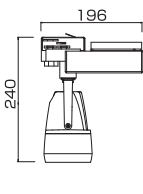

[Specification]  
Power Consumption : 30.2W (@240V)  
Input Voltage : 100-240VAC (50/60Hz)  
Luminous flux : 2569 lm (Medium 4000K)  
CCT : 2700K/3500K/4000K  
CRI : 93  
Weight : 1.3kg  
Lifetime : 40000 hours\*

[Beam Angle]  
▲ Medium ▲ Wide

OPTIONS

[Glass Filters]

Super Market



\*=Operating environment: below 30°C. Estimated lifetime is determined as the total operating hour until the end of life of LED module or total operating our until total lumen output decreases to the 70% of initial total lumen output (L70).



# Color Selectable Track Lights



# Installation examples



Premium Line

LED 40w

●2700K/3500K/4000K  
OECD-EU40(White/Black)  
[Normal Type]

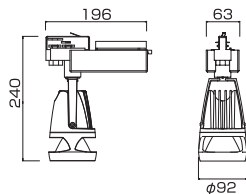

[Specification]  
Power Consumption : 37.7W (@240V)  
Input Voltage : 100-240VAC (50/60Hz)  
Luminous flux : 3015 lm (Medium 4000K)  
CCT : 2700K/3500K/4000K  
CRI : 93  
Weight : 1.1kg  
Lifetime : 40000 hours \*

[Beam Angle]  
▲ Medium ▲ Wide

Premium Line

LED 40w

●2700K/3500K/4000K  
OECD-EUS40(White/Black)  
[Anti-dazzle Type]

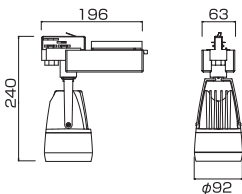

[Specification]  
Power Consumption : 37.7W (@240V)  
Input Voltage : 100-240VAC (50/60Hz)  
Luminous flux : 3015 lm (Medium 4000K)  
CCT : 2700K/3500K/4000K  
CRI : 93  
Weight : 1.3kg  
Lifetime : 40000 hours \*

[Beam Angle]  
▲ Medium ▲ Wide

## OPTIONS

[Glass Filters]

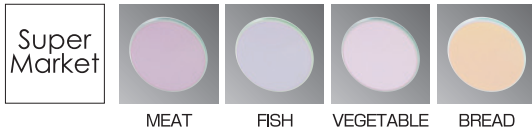

\*=Operating environment: below 30°C. Estimated lifetime is determined as the total operating hour until the end of life of LED module or total operating our until total lumen output decreases to the 70% of initial total lumen output (L70).





# Color Selectable Track Lights



LED 20w  
●3000K/4000K  
OFND-CAS/20(White)

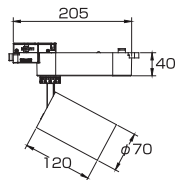

[Specification]  
Power Consumption : 23.0W (@240V)  
Input Voltage : 100-240VAC (50/60Hz)  
Luminous flux :1786 lm (Medium 3000K)  
CCT : 3000K/4000K  
CRI : 80  
Weight : 1.0kg  
Lifetime : 40000 hours \*

[Beam Angle]  
▲ Narrow ▲ Medium

LED 20w  
●3000K/4000K  
OFND-CAS/20(Black)

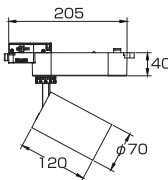

[Specification]  
Power Consumption : 23.0W (@240V)  
Input Voltage : 100-240VAC (50/60Hz)  
Luminous flux :1786 lm (Medium 3000K)  
CCT : 3000K/4000K  
CRI : 80  
Weight : 1.0kg  
Lifetime : 40000 hours \*

[Beam Angle]  
▲ Narrow ▲ Medium

# Color Selectable Track Lights



LED 30w  
●3000K/4000K  
OFND-CAS/30(White)

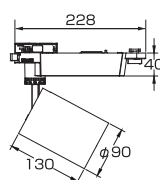

[Specification]  
Power Consumption : 28.0W (@240V)  
Input Voltage : 100-240VAC (50/60Hz)  
Luminous flux : 2675 lm (Medium 3000K)  
CCT : 3000K/4000K  
CRI : 80  
Weight : 1.5kg  
Lifetime : 40000 hours \*

[Beam Angle]  
▲ Narrow ▲ Medium

LED 30w  
●3000K/4000K  
OFND-CAS/30(Black)

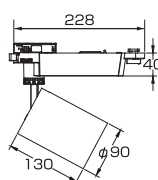

[Specification]  
Power Consumption : 28.0W (@240V)  
Input Voltage : 100-240VAC (50/60Hz)  
Luminous flux : 2675 lm (Medium 3000K)  
CCT : 3000K/4000K  
CRI : 80  
Weight : 1.5kg  
Lifetime : 40000 hours \*

[Beam Angle]  
▲ Narrow ▲ Medium

## OPTIONS

[Glass Filters]

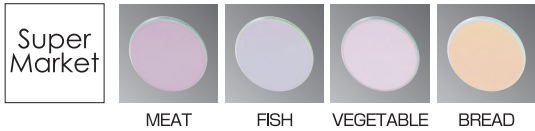

\*=Operating environment: below 30°C. Estimated lifetime is determined as the total operating hour until the end of life of LED module or total operating our until total lumen output decreases to the 70% of initial total lumen output (L70).

## OPTIONS

[Glass Filters]

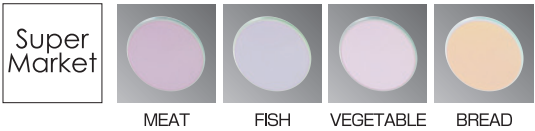

\*=Operating environment: below 30°C. Estimated lifetime is determined as the total operating hour until the end of life of LED module or total operating our until total lumen output decreases to the 70% of initial total lumen output (L70).



# Color Selectable Track Lights



# Color Selectable Track Lights



LED 20w  
●3000K/4000K  
OFND-AS/20(White)

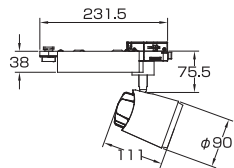

[Specification]  
Power Consumption : 17.0W (@240V)  
Input Voltage : 100-240VAC (50/60Hz)  
Luminous flux : 1126 lm (Medium 4000K)  
CCT : 3000K/4000K  
CRI : 90  
Weight : 1.2kg  
Lifetime : 40000 hours \*

[Beam Angle]  
▲ Narrow ▲ Medium

LED 20w  
●3000K/4000K  
OFND-AS/20(Black)

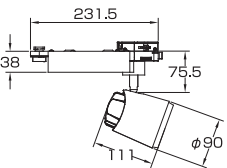

[Specification]  
Power Consumption : 17.0W (@240V)  
Input Voltage : 100-240VAC (50/60Hz)  
Luminous flux : 1126 lm (Medium 4000K)  
CCT : 3000K/4000K  
CRI : 90  
Weight : 1.2kg  
Lifetime : 40000 hours \*

[Beam Angle]  
▲ Narrow ▲ Medium

LED 40w  
●3000K/4000K  
OFND-AS/40(White)

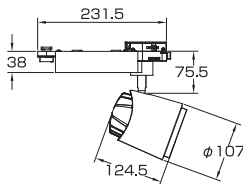

[Specification]  
Power Consumption : 41.5W (@240V)  
Input Voltage : 100-240VAC (50/60Hz)  
Luminous flux : 2526 lm (Medium 4000K)  
CCT : 3000K/4000K  
CRI : 90  
Weight : 1.3kg  
Lifetime : 40000 hours \*

[Beam Angle]  
▲ Narrow ▲ Medium

LED 40w  
●3000K/4000K  
OFND-AS/40(Black)

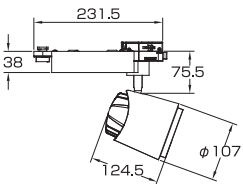

[Specification]  
Power Consumption : 41.5W (@240V)  
Input Voltage : 100-240VAC (50/60Hz)  
Luminous flux : 2526 lm (Medium 4000K)  
CCT : 3000K/4000K  
CRI : 90  
Weight : 1.3kg  
Lifetime : 40000 hours \*

[Beam Angle]  
▲ Narrow ▲ Medium

## OPTIONS

[Glass Filters]

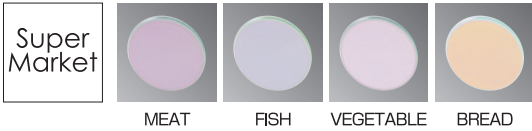

\*=Operating environment: below 30°C. Estimated lifetime is determined as the total operating hour until the end of life of LED module or total operating our until total lumen output decreases to the 70% of initial total lumen output (L70).

## OPTIONS

[Glass Filters]

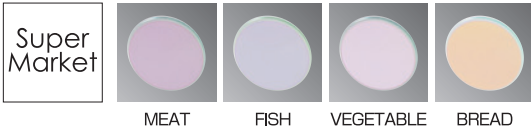

\*=Operating environment: below 30°C. Estimated lifetime is determined as the total operating hour until the end of life of LED module or total operating our until total lumen output decreases to the 70% of initial total lumen output (L70).



# Color Selectable Track Lights



## LED 30W

●2700K/3000K/3500K/4000K  
OMO-SPT30W-01(White)

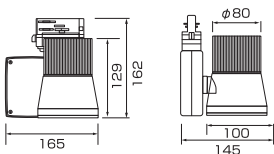

[Specification]  
Power Consumption : 31W (@240V)  
Input Voltage : 220-240VAC (50/60Hz)  
Luminous flux : 2506 lm (Wide 3000K)  
CCT : 2700K/3000K/3500K/4000K  
CRI : 80  
Weight : 1.0kg  
Lifetime : 40000 hours\*

[Beam Angle]  
▲ Medium ▲ Wide

## LED 30W

●2700K/3000K/3500K/4000K  
OMO-SPT30W-01(Black)

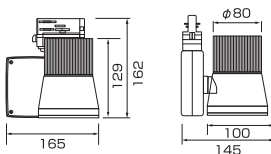

[Specification]  
Power Consumption : 31W (@240V)  
Input Voltage : 220-240VAC (50/60Hz)  
Luminous flux : 2506 lm (Wide 3000K)  
CCT : 2700K/3000K/3500K/4000K  
CRI : 80  
Weight : 1.0kg  
Lifetime : 40000 hours\*

[Beam Angle]  
▲ Medium ▲ Wide

## LED 30W

●2700K/3000K/3500K/4000K  
OMO-SPT30W-01(Grey)

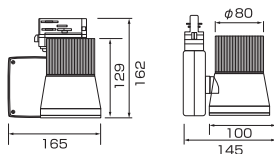

[Specification]  
Power Consumption : 31W (@240V)  
Input Voltage : 220-240VAC (50/60Hz)  
Luminous flux : 2506 lm (Wide 3000K)  
CCT : 2700K/3000K/3500K/4000K  
CRI : 80  
Weight : 1.0kg  
Lifetime : 40000 hours\*

[Beam Angle]  
▲ Medium ▲ Wide

## LED 30W

●2700K/3000K/3500K/4000K  
OMO-1DWN30W-01

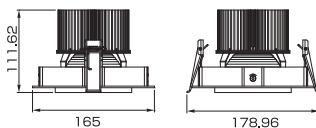

[Specification]  
Power Consumption : 31.1W (@240V)  
Input Voltage : 220-240VAC (50/60Hz)  
Luminous flux : 2349 lm (Wide 3000K)  
CCT : 2700K/3000K/3500K/4000K  
CRI : 80  
Weight : 0.8kg (Power Supply 0.4kg)  
Lifetime : 40000 hours\*

[Beam Angle]  
▲ Narrow ▲ Medium ▲ Wide

## LED 30W

●3000K  
OMO-1DWN30W-04

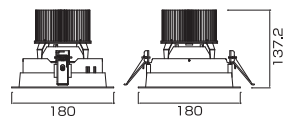

[Specification]  
Power Consumption : 31.1W (@240V)  
Input Voltage : 220-240VAC (50/60Hz)  
Luminous flux : 2305 lm (Medium)  
CCT : 3000K  
CRI : 80  
Weight : 1.0kg (Power Supply 0.4kg)  
Lifetime : 40000 hours\*

[Beam Angle]  
▲ Narrow ▲ Medium ▲ Wide

## LED 30W x2

●3000K  
OMO-2DWN30W-04

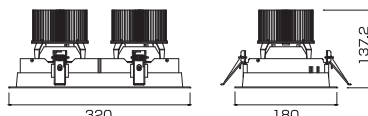

[Specification]  
Power Consumption : 31.1W x2 (@240V)  
Input Voltage : 220-240VAC (50/60Hz)  
Luminous flux : 2305 lm x2 (Medium)  
CCT : 3000K  
CRI : 80  
Weight : 1.9kg (Power Supply 0.4kg x2)  
Lifetime : 40000 hours\*

[Beam Angle]  
▲ Narrow ▲ Medium ▲ Wide

### OPTIONS

[Glass Filters]

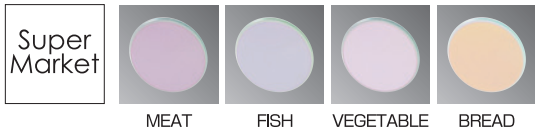

\*=Operating environment: below 30°C. Estimated lifetime is determined as the total operating hour until the end of life of LED module or total operating our until total lumen output decreases to the 70% of initial total lumen output (L70).

# Color Selectable Downlights



### OPTIONS (For OMO-1DWN30W-01)

[Glass Filters]

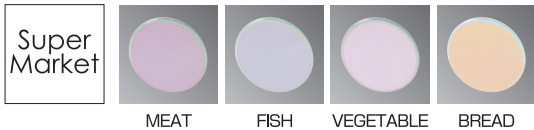

\*=Operating environment: below 30°C. Estimated lifetime is determined as the total operating hour until the end of life of LED module or total operating our until total lumen output decreases to the 70% of initial total lumen output (L70).



## Corporate Profile

<b>Corporate Name</b>	LED OKAMURA HK LIMITED
<b>President</b>	SACHIO OKAMURA
<b>General Manager</b>	RURU FUKAZAWA
<b>Foundation</b>	October, 2012
<b>Capital</b>	1 million HK Dollars
<b>Accounting Period</b>	End of September
<b>Head Office</b>	Unit 604, 6/F, Wing On Plaza, 62 Mody Road, Tsimshatsui, Kowloon, HK
<b>Overseas</b>	Vietnam
<b>Products &amp; Services</b>	Manufacturing and sales of special LED and lamps, lighting products for food and shops

## Company Policy

Our company adopt an international point of view and continue to create and challenge itself. We do our utmost to be an excellent company which contributes to our society by providing best services and best products in order to satisfy our customer.

## Comprehensive capabilities to meet all our customer' s needs

As an illumination planner, we do not only produce fixtures depending of the type of industry and/or the use but we can also manufacture various optics products and special order lighting equipment on demand.

- 1 Manufacturing and sale of original lighting fixtures and lamps
- 2 Illumination planning
- 3 Manufacturing and sale of optical products
- 4 Customer service

## Corporate Philosophy

### 1 Activity' s Policy

We will fulfill our corporate social responsibilities and respect social culture and values, in compliance with the law of each country.

### 2 Communication and teamwork in the company

Which makes the company is "People" Without teamwork and good relation between employee "People" will not be able to perform at their best and so unable to reach any goal.

### 3 Customer First

Whatever is customer request or needs, we will do or utmost to fulfill them it thanks to our best partners and excellent customer service.

### 4 We are always continue to try new things

With a strong challenger' s spirit, we will promote projects and businesses to answer various problems.

### 5 Aware of our company' s vision

We will make a worthful and proudful company. We want to be a company contributing to the world.

## Corporate History

<b>Oct, 2012</b>	Established in HK
<b>Jan, 2013</b>	LED Sign Light Up

## LED OKAMURA LED OKAMURA HK LIMITED

<http://www.ledokamura.com.hk>

Unit 604, 6/F, Wing On Plaza,  
62 Mody Road, Tsimshatsui, Kowloon, HK

TEL : +852 - 2722 -1776  
FAX : +852 - 2722 -1773  
e-mail : [info@ledokamura.com.hk](mailto:info@ledokamura.com.hk)  
Overseas : Vietnam

## Access Map

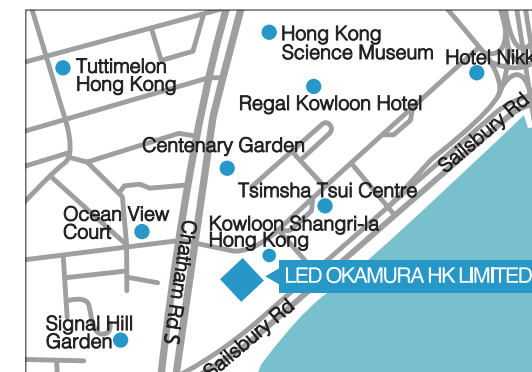

## LED OKAMURA OKAMURA ELECTRIC CORPORATION

<http://okamura-densan.co.jp/>

1F , Akasaka NOA Building , 3-2-12 , Akasaka , Minato-ku ,  
Tokyo 107-0052 , JAPAN  
e-mail : [tokyo@okamura-densan.co.jp](mailto:tokyo@okamura-densan.co.jp)

Branch Office : Tokyo / Osaka / Fukuoka / Nagoya / Sendai / Kanazawa / Chiba  
Overseas : Nanning

## Chapelle Foujita

33 rue du Champ de Mars  
51100 REIMS  
FRANCE



In the winter of 2013, we donated our LED lamps to Foujita chapel in Reims France.

Even now, Tsuguharu Foujita remains the most famous Japanese artist in France. For the lighting fixture replacement project of the Foujita chapel that he designed, built and decorated in 1965 (his last work before his death) our Eco-No-Suke Premium's LED lamp has been selected after a very strict examination. It has been chosen for his high CRI feature and his impressive energy saving with a 90% power consumption reduction compare to the light solution used at the time. In October 2013, all existing halogen lamps have been changed for our LED lamps letting the chapel be enlightened by a completely new light. The biggest features of our LED lamp, his excellent CRI and color reproduction property allowed the chapel to regain his original color and texture, which could not be enjoyed with the existing lighting. In result, revived fresco inside the chapel has received very high praise from Reims city's people in France.

